

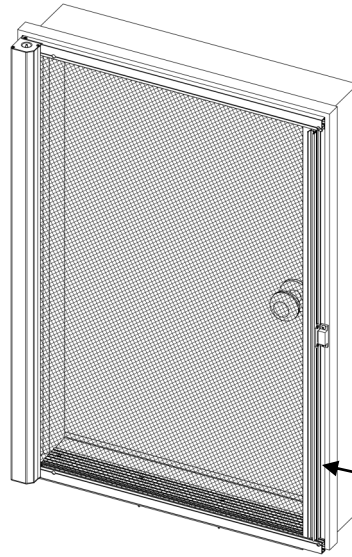

# Installation instructions

Inswing Door  
face mount  
Figure A



Hardware:	
sill extender =>	(4) 1" s/s screws
2 tracks =>	(4) 5/8" screws (2) 1" screws
Handle =>	(3) 3/8" screws
striker plate =>	(2) 3/8" screws
Magnet =>	(2) 3/4" white screws

Mole hair goes between handle bar and brick moulding

Cut and notch the sill extender to fit between door casing.

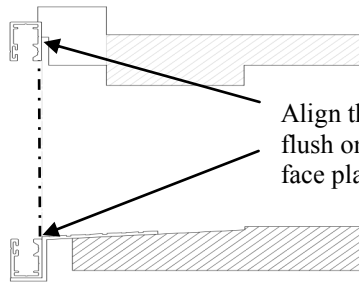
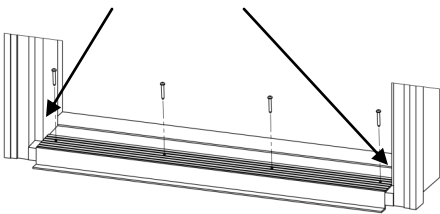

Align the sill extender to sit flush on the mounting surface plane.



Install and secure tracks.

Transfer hole locations for handle and striker plate, and use 7/64" drill through first wall of material only.

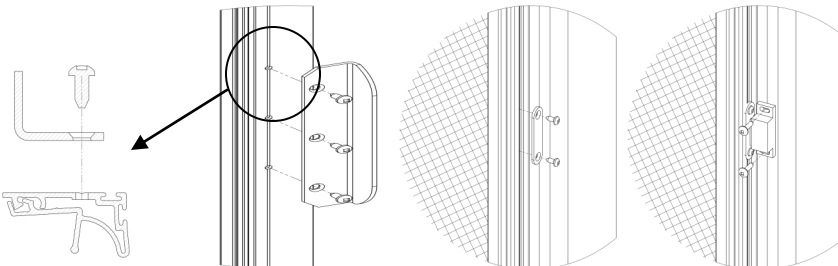

Slide mole hair out of the way prior to 1/8" pilot hole for #1,#2: fasten #1,#4: snug only.

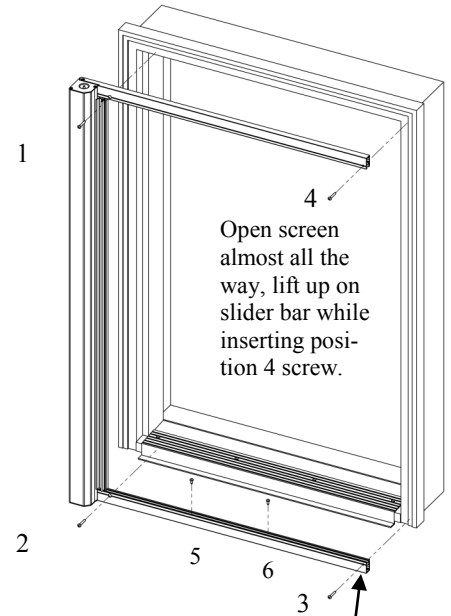

5/32" clearance hole on mounting groove 1/4" from the end for #3&#4